

180 (7')

±130 (5')



53 (2')

up to 3000 (10') standard

up to 30500 (100') custom

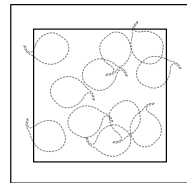
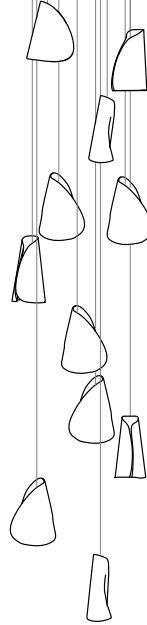

378 (15')

508 (20')

approx 16.1kg (35.5lb)

- PENDANTS: eleven
- MOUNTING: white powder coated square canopy 508 (20") x 53mm (2") deep
- LAMPING: 1.5w LED or 20w xenon
- COAX: non-adjustable lengths. 3000mm (10') standard / up to 30500mm (100') maximum
- MATERIALS: porcelain, borosilicate glass, braided metal coaxial cable, electrical components, white powder coated canopy
- WEIGHT: approximately 16.1kg (35.5lb)
- POWER SUPPLIES: integral

#### DESCRIPTION

21.11 is a random configuration of eleven 21 pendants hung from a square canopy. The drop lengths of the pendants are randomized between a client specified range of heights to variously cluster and scatter. The result is an ambient installation or field of light.

Inspired by the sporadic, discordant arrangement of barnacles on a rock surface, the 21 is fabricated from thin sheets of porcelain wrapped around a trumpet shaped borosilicate diffuser. Each diffuser houses a low voltage lamp. A strong contrast is established between the organically distributed soft light passing through the white porcelain skin and the sharp, crisp light passing through the borosilicate glass diffuser.

#### NOTES

- + Purchase replacement lamps online at [www.bocci.com/shop/bulbs](http://www.bocci.com/shop/bulbs)
- + Unless otherwise noted when ordering, all chandeliers will be outfitted to be xenon compatible.
- + As an alternative to built-in power supplies, Bocci recommends mounting power supplies remotely in an easily accessible and hidden location for ease of long-term maintenance.

US patent # US D556,361  
Worldwide patents issued and pending.

Made in Vancouver, Canada

Vancouver  
sales@bocci.com  
www.bocci.com

Berlin  
europe@bocci.com  
www.bocci.com

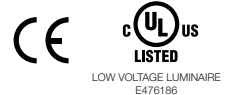

SQUARE

# 21.11

Design by Omer Arbel  
PRODUCT SPECIFICATION

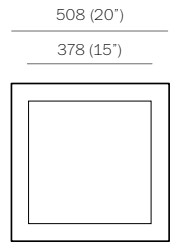

1

Note: All connections and power supplies are tested by our technicians before shipping. However, it is possible for ports/ power supplies to come loose or damage during shipping.

Test each port before installing canopy to ceiling to catch any loose connections or faulty power supplies.

Measure and mark the light fixture canopy position on the ceiling

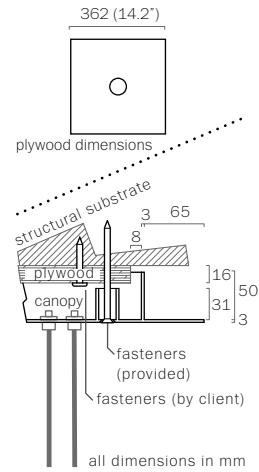

2

Note: The client is responsible for providing a robust 16mm (5/8") plywood backing or wood blocking to securely anchor to the structural substrate.

Connections from the plywood to the structural substrate are the client's responsibility.

Measure the plywood so that it fits within the canopy side walls (refer to detail above).

Anchor the plywood backing to the structural ceiling substrate.

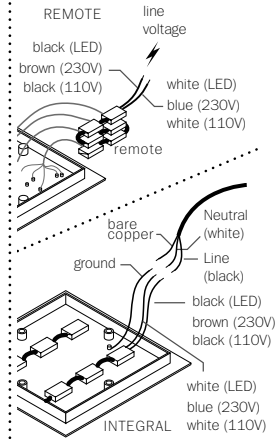

3

Connect power supplies to line voltage.

Xenon (110V) or LED: connect the black wire to black and white wire to white wire.

Xenon (230V): connect black wire to brown wire and white wire to blue wire.

For the ground connection, connect the green wire with yellow stripe to the bare copper wire or green wire in the junction box.

Note: Bocci strongly recommends mounting power supplies remotely in a close, accessible and hidden location for ease of long term maintenance. Installation to be done by certified personnel to ensure compliance with the code.

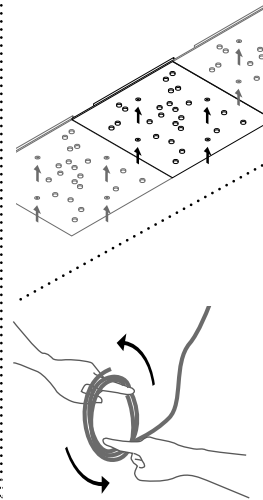

4

Anchor canopy into the plywood backing using the fasteners provided.

**Turn power to fixture on.**

Very carefully uncoil the braided coaxial cable in a spool like manner. Insert your index fingers into opposite sides of the roll then rotate your fingers around each other to unroll the coaxial cable.

Use patience: allow the cable to uncoil completely to avoid kinks.

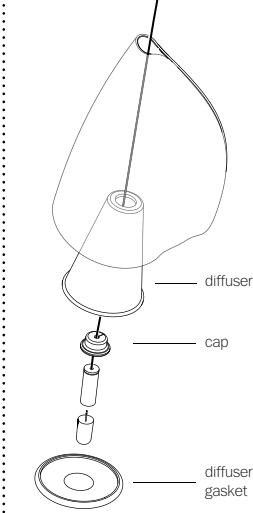

5

Bocci LED or xenon lamps are included. Lamping is power supply specific.

Plug the lamp into the socket. Do not touch the lamp with your bare hands. Ensure power to lamp is working correctly.

Thread the coaxial cable through the shade, followed by the borosilicate diffuser, the cap, and finally close off the diffuser with the diffuser gasket.

6

Each pendant terminates in a "headphone jack" type connector, which plugs into a receiving receptacle in the canopy. Clients are encouraged to compose their own pendant configuration on site, thus creating a truly unique fixture. After plugging in each pendant, turn the threaded sheath into place by hand ensuring that it is adequately tightened. Tools are not required.

Check that each lamp is working properly as you go along by keeping power to the fixture on and lamps plugged in.

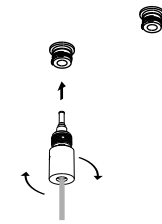

7

Each pendant terminates in a "headphone jack" type connector, which plugs into a receiving receptacle in the canopy. Clients are encouraged to compose their own pendant configuration on site, thus creating a truly unique fixture. After plugging in each pendant, turn the threaded sheath into place by hand ensuring that it is adequately tightened. Tools are not required.

For additional assistance, please contact Bocci:

Vancouver  
sales@bocci.com  
www.bocci.com

Berlin  
europe@bocci.com  
www.bocci.com

US patent # US D556,361

Worldwide patents issued and pending.

Made in Vancouver, Canada



SQUARE

21.11

Design by Omer Arbel  
PRODUCT INSTALLATION INSTRUCTIONS

© 2021, Bocci Design and Manufacturing Inc. All rights reserved. Any inquiries should be directed to: info@bocci.com

**BOCCI**