

up to
3000
(10')
standard

up to
24600
(80')
custom

±100-165 (4-6')

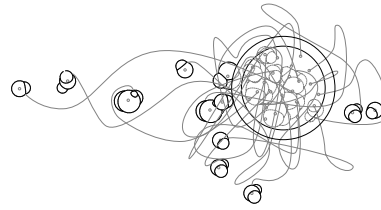

470 (18.5')

600 (23.6')

- PENDANTS: twenty-six
- MOUNTING: white powder coated round canopy 600mm (23.6") in diameter x 53mm (2") deep
- LAMPING: grey and dark mirrored: 1.5w LED (39w total)
white opaline and light mirrored: 1.5w LED / 0.18w LED (43.68w total)
- CABLE: fixed lengths. 3000mm (10') standard / up to 30500mm (100') maximum
- MATERIALS: blown and dipped glass, cast borosilicate glass cap, white powder-coated steel hardware and swag hooks, braided metal coaxial cable, aircraft cable, swag jack rings, electrical components.
- WEIGHT: approximately 61kg (137lb)
- POWER SUPPLIES: integral (remote mount recommended)

DESCRIPTION

57.26 is a random configuration of twenty-six 57 pendants suspended from a white powder coated canopy. This fixture is designed to be horizontal, meaning that the pendants don't hang directly below, but instead trail off across a space, around a corner or simply deviate from their gravitational directive. As such, this fixture is designed to be hung from any number of optional swag points.

57 is an exploration of a technique used for producing closed cell foam. The process involves trapping voids of air of different sizes and configurations within a glass matrix, yielding a shape loosely referencing a rain cloud. These pockets of air remain invisible when the piece is off, but come alive to reveal an interior universe when the piece is illuminated. By virtue of the fabrication process, each piece is completely unique.

NOTES

+ Purchase replacement lamps online at www.bocci.com/shop/bulbs

US Patent # D796 732
EU Patent # 002268581-0001 to 0006

Made in Vancouver, Canada

Vancouver
sales@bocci.com
www.bocci.com

Berlin
europe@bocci.com
www.bocci.com

approx 61kg (137lb)

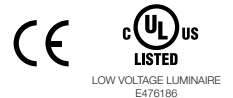

57.26

Design by Omer Arbel
PRODUCT SPECIFICATION

© 2020, Bocci Design and Manufacturing Inc. All rights reserved. Any inquiries should be directed to: info@bocci.com

BOCCI

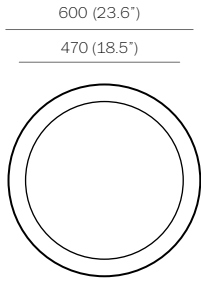

1

Note: All connections and power supplies are tested by our technicians before shipping. However, it is possible for ports/ power supplies to come loose/ damage during shipping.

Test each port before installing canopy to ceiling to catch any loose connections or faulty power supplies.

Measure and mark the light fixture canopy position on the ceiling

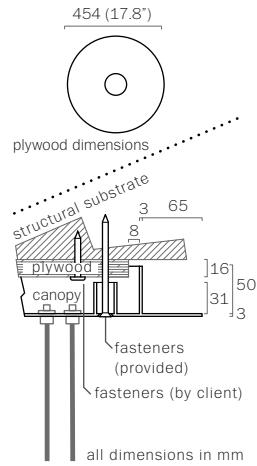

2

Note: The client is responsible for providing a robust 16mm (5/8") plywood backing or wood blocking to securely anchor to the structural substrate.

Connections from the plywood to the structural substrate are the client's responsibility.

Measure the plywood so that it fits within the canopy side walls (refer to detail above).

Anchor the plywood backing to the structural ceiling substrate.

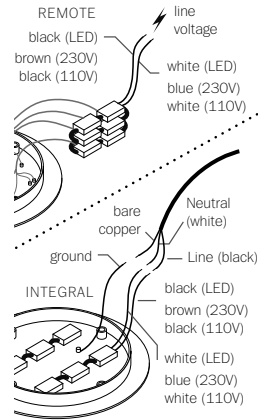

3

Connect power supplies inside the canopy to line voltage.

LED: connect the black wire to black and white wire to white wire.

For the ground connection, connect the green wire with yellow stripe to the bare copper wire or green wire in the junction box.

Note: Bocci recommends mounting power supplies remotely in a close, accessible and hidden location for ease of long term maintenance. Installation to be done by certified personnel to ensure compliance with the code.

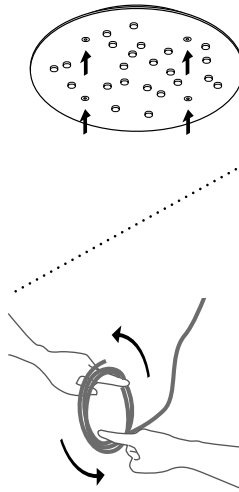

4

Anchor canopy into the plywood backing using the fasteners provided.

Turn power to fixture on.

Very carefully uncoil the braided coaxial cable in a spool like manner. Insert your index fingers into opposite sides of the roll then rotate your fingers around each other to unroll the coaxial cable.

Use patience: allow the cable to uncoil completely to avoid kinks.

GREY / DARK MIRRORED

WHITE OPALINE / LIGHT MIRRORED

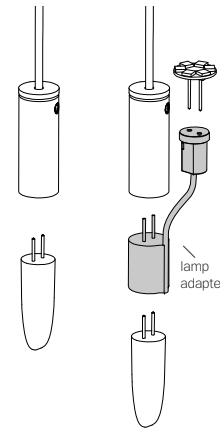

5

For grey and dark mirrored, attach lamp to the coax socket.

For white opaline and light mirrored, slide the coax holder onto the coaxial cable.

Plug in lamps, with the circular LED array lamp facing towards the coax holder.

Ensure power to lamp is working correctly.

6

Each pendant terminates in a "headphone jack" type connector, which plugs into a receiving receptacle in the canopy. Clients are encouraged to compose their own pendant configuration on site, thus creating a truly unique fixture. After plugging in each pendant, turn the threaded sheath into place by hand ensuring that it is adequately tightened. Tools are not required.

Check that each lamp is working properly as you go along by keeping power to the fixture on and lamps plugged in.

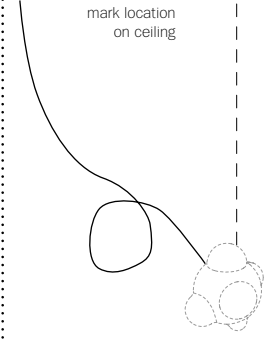

7

Mark the location for the swag hook screw on the ceiling.

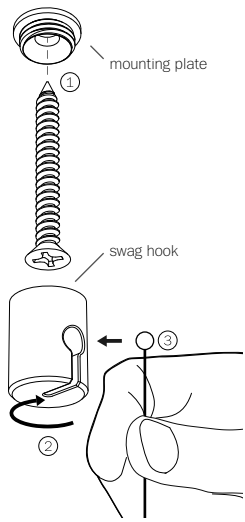

8

Ensure that the ceiling at the swag location is strong enough to hold 2kg (5lbs) before attaching swag hook with the provided screws.

Thread the swag hook on to the mounting plate, ensuring all the threads are engaged.

Slide the ball end of the aircraft into the slot on the swag hook.

Note: Some installations call for the use of a swag jack ring, which allows pendants to be swagged from the canopy.

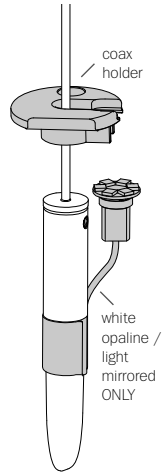

9

Slide the coax holder onto the coaxial cable.

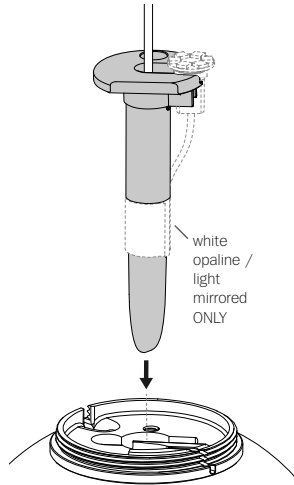

10

For white opaline/light mirrored, rest the circular LED array lamp on the coax holder.

Insert the lamp assembly into the glass pendant.

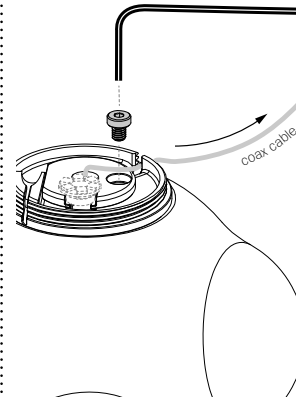

11

Attach the coax holder to the pendant holder and secure with set screw.

Slide the coax cable through the slot on the pendant holder

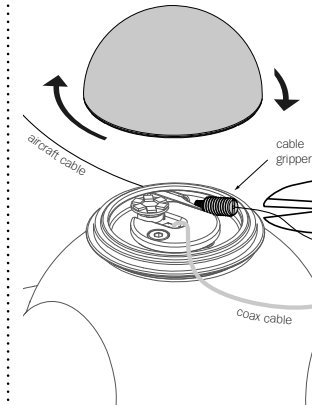

12

Feed the aircraft cable into the cable gripper. Slide the cable gripper into channel housing of the pendant holder. Pull the aircraft cable and slide the cable gripper to adjust the height.

Cut the aircraft cable using wire cutters.

Thread glass cap onto the pendant, ensuring that the coax remains seated in the slot.

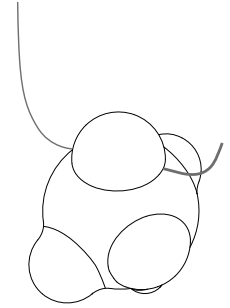

13

Clean fingerprints from surfaces.

For additional assistance, please contact Bocci:

Vancouver
sales@bocci.com
www.bocci.com

Berlin
europe@bocci.com
www.bocci.com

US Patent # D796 732
EU Patent # 002268581-0001 to 0006

Made in Vancouver, Canada

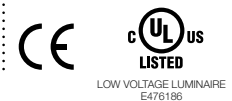

57.26

Design by Omer Arbel
PRODUCT INSTALLATION INSTRUCTIONS

© 2020, Bocci Design and Manufacturing Inc. All rights reserved. Any inquiries should be directed to: info@bocci.com

BOCCI