

±140 (5.5')

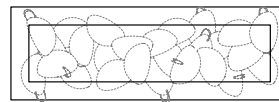

870 (34.3')

1000 (39.4')

53
(2')

up to
3000
(10')
standard

up to
30500
(100')
custom

205
(8')

335
(13.2')

PENDANTS: twenty-six

MOUNTING: white powder coated rectangular canopy 1000mm (39.4') x 335mm (13.2') x 53mm (2') deep

LAMPING: 0.4w LED

COAX: fixed lengths. 3000mm (10') standard / up to 30500mm (100') maximum

MATERIALS: blown glass, copper mesh, braided metal coaxial cable, electrical components, white powder coated canopy

WEIGHT: approximately 28.2kg (62lb)

POWER SUPPLIES: integral

DESCRIPTION

76.26 is a random configuration of twenty-six 76 pendants hung from a rectangular canopy. The drop lengths of the pendants are randomized between a client specified range of heights to variously cluster and scatter. The result is an ambient installation or field of light.

A vacuum is introduced to a strata composed of hot white and clear glass with copper mesh between. The vacuum causes the white layer to pull away through the embedded mesh, leaving numerous tendrils of white glass suspended within an interstitial space as it goes.

NOTES

- + Purchase replacement lamps online at www.bocci.com/shop/bulbs
- + As an alternative to built-in drivers, Bocci recommends mounting drivers remotely in an easily accessible and hidden location for ease of long-term maintenance.
- + Please note that the copper mesh used within the 76 may be affected by heat and oxidization during the glass blowing process. These small oxidized edges can sometimes separate within the pendant; this is a natural characteristic of the metal and is seen as an evolution of the piece as it ages.

US Patent # D817,524 S

EU Design Patent # 002840975-0004-0007

Made in Vancouver, Canada

Vancouver
sales@bocci.com
www.bocci.com

Berlin
europe@bocci.com
www.bocci.com

approx 28.2kg (62lb)

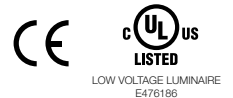

RECTANGLE

76.26

PRODUCT SPECIFICATION

© 2021, Bocci Design and Manufacturing Inc. All rights reserved. Any inquiries should be directed to: info@bocci.com

BOCCI

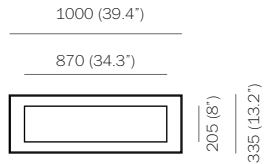

1

Note: All connections and power supplies are tested by our technicians before shipping. However, it is possible for ports/ power supplies to come loose or damage during shipping.

Test each port before installing canopy to ceiling to catch any loose connections or faulty power supplies.

Measure and mark the light fixture canopy position on the ceiling

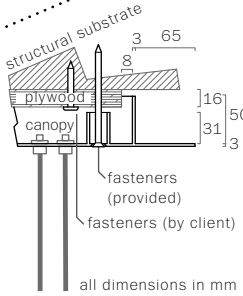
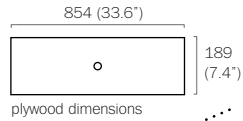

2

Note: The client is responsible for providing a robust 16mm (5/8") plywood backing or wood blocking to securely anchor to the structural substrate.

Connections from the plywood to the structural substrate are the client's responsibility.

Measure the plywood so that it fits within the canopy side walls (refer to detail above).

Anchor the plywood backing to the structural ceiling substrate.

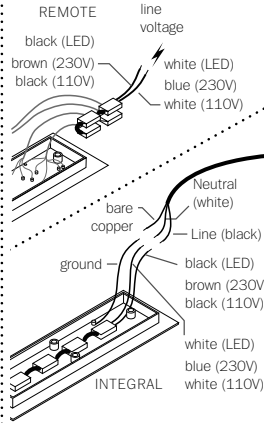

3

Connect drivers inside the canopy to line voltage.

Connect the black wire to black and white wire to white wire.

For the ground connection, connect the green wire with yellow stripe to the bare copper wire or green wire in the junction box.

Note: As an option, Bocci recommends mounting drivers remotely in a close, accessible and hidden location for ease of long term maintenance. Installation to be done by certified personnel to ensure compliance with the code.

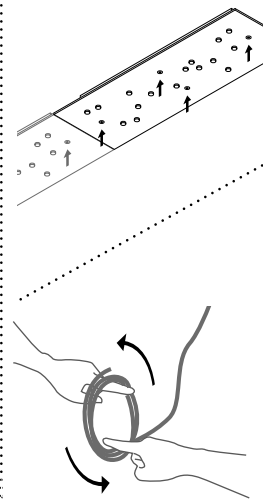

4

Anchor canopy into the plywood backing using the fasteners provided.

Turn power to fixture on.

Very carefully uncoil the braided coaxial cable in a spool like manner. Insert your index fingers into opposite sides of the roll then rotate your fingers around each other to unroll the coaxial cable.

Use patience: allow the cable to uncoil completely to avoid kinks.

5

Each pendant terminates in a "headphone jack" type connector, which plugs into a receiving receptacle in the canopy. Clients are encouraged to compose their own pendant configuration on site, thus creating a truly unique fixture. After plugging in each pendant, turn the threaded sheath into place by hand ensuring that it is adequately tightened. Tools are not required.

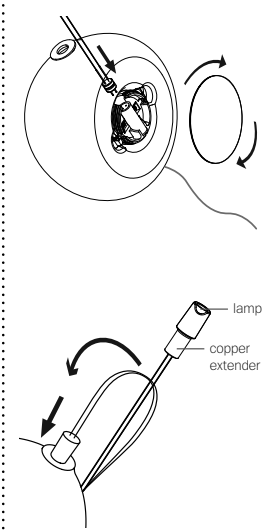

6

Remove the centre cap from 76 pendant. Install lampholder at the end of the coaxial cable into the groove in the pendant hardware.

Bocci 0.4w LED lamps are included. Plug the lamp into flexible copper extender. Check that each lamp is working properly as you go along.

Hold lamp wires away from the pendant to ensure they do not interfere with spinning cap.

Thread centre cap back on to pendant hardware.

DO NOT OVERTIGHTEN.

Bend the insulated wires and insert the lamp into the small hole in the pendant. Ensure that the lamp does not touch the inner glass bubble.

Note: when using a dimmer use only low voltage electronic dimmer

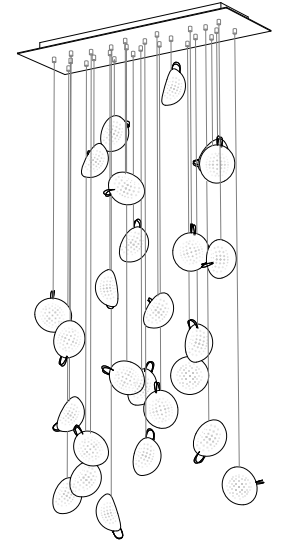

7

Clean fingerprints from surfaces.

For additional assistance, please contact Bocci:

Vancouver
sales@bocci.com
www.bocci.com

Berlin
europe@bocci.com
www.bocci.com

US Patent Pending

EU Design Patent #
002840975-0004-0007

Made in Vancouver, Canada



RECTANGLE

76.26

PRODUCT INSTALLATION INSTRUCTIONS

© 2021, Bocci Design and Manufacturing Inc. All rights reserved. Any inquiries should be directed to: info@bocci.com

BOCCI